



Matrix Orbital

Mounting Bezel Instructions
BEZ-204A-V1-W-OEM

Contact

support@matrixorbital.ca
sales@matrixorbital.ca
(403) 229-2737
www.matrixorbital.ca
www.matrixorbital.com
www.lcdforums.com

Package Contents

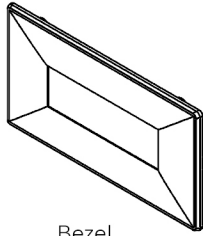

Bezel

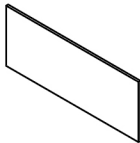

Window

This version of Matrix Orbital's mounting bezel does not come with any hardware or accessories. All screws and hardware are to be supplied by the user. A printable copy of the cut out guide can be found at www.matrixorbital.ca, in the manuals section.

For mounting all models, the following hardware is required:

- 2, #4-40 x 1/8" Screws
- 2, Cup Washers

For most models, the following is also required:

- 4, #4-40 x 5/8" Screws
- 4, 6mm Spacers

For OK Series, the following is also required:

- 4, #4-40 x 3/8" Screws
- 4, 1/16" Spacers

For GLK Series, the following is also required:

- 4, #4-40 x 3/8" Screws
- 4, 6mm Spacers

Directions

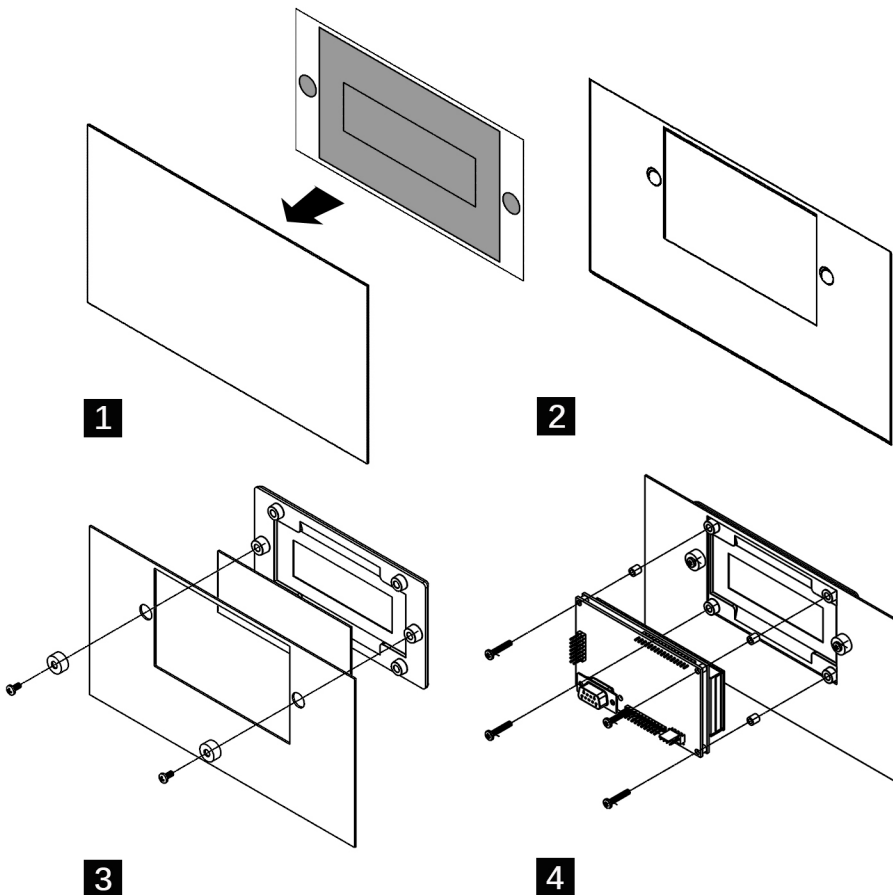

Before starting, choose location on panel for Bezel, ensuring adequate clearance inside of enclosure.

- 1** Place Cut Out Guide on outside of panel at desired location, using the text for correct orientation.
- 2** Cut hole along solid lines, removing shaded area. Drill out circular areas using 9.5mm or 3/8" bit. Remove Cut Out Guide.
- 3** Remove protective film from Window. Affix Window to Bezel. Attach Bezel to panel using Cup Washers and 1/8" Screws. Be careful to not over tighten.
- 4** Attach display to Bezel using appropriate Screws and Spacers.